

# Rubber Expansion Joint highFLEX SFR - STD

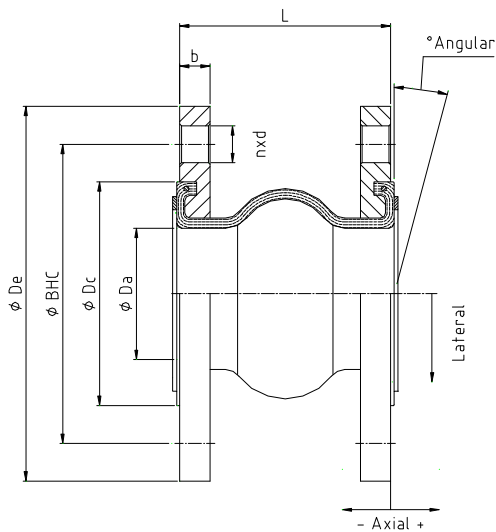

## Rubber material

EPDM, Butyl, Nitrile, Neoprene, Hypalon, Viton  
Different inside- and outside coatings are possible.

## Make up

Deep convoluted, high flexible bellow Nyloncord reinforcement. The wire reinforced rubber joint face (packing profile) is self-sealing.

## Flanges

Both sides with galvanized swivel metal flanges with drilled bolt holes.  
Dimensions according to DIN PN 10 / 16 or ANSI 150 lbs. For dimensions of please refer to the enclosed table. Special flanges are available on request.

## Pressure range

Maximum operating pressure according to table for max. 80 °C (please contact supplier for higher operation temperature). For shock load the operating pressure is reduced to 70 %.

The maximum operating pressure can be calculated with the temperature related factors.

85 °C = 0.92      90 °C = 0.83  
95 °C = 0.75      100 °C = 0.67  
105 °C = 0.60

Vacuum:                      880 mbar up to DN 600 without supporting ring  
   > DN 600 supporting ring is necessary \*  
Burst pressure:              DN 32 - DN 300 = 60 bar  
   DN 350 - DN 600 = 24 bar  
Maximum Temperature:    -10 to +105 °C

DN - nominal size mm (in.)	Da mm	Dc mm	b mm	L mm	Axial +mm	Axial -mm	Lateral mm	Angular (°)	Max. pressure bar up to +80 °C	Max. Temp. + °C	Vacuum mbar
32 (1 1/4")	37	68	16	95	4	8	8	15	16	105	880
40 (1 1/2")	37	68	16	95	4	8	8	15	16	105	880
50 (2")	50	86	16	105	5	8	8	15	16	105	880
65 (2 1/2")	65	106	16	115	6	12	10	15	16	105	880
80 (3")	72	118	18	130	6	12	10	15	16	105	880
100 (4")	98	152	18	135	10	18	12	15	16	105	880
125 (5")	122	182	20	170	10	18	12	15	16	105	880
150 (6")	146	213	22	180	10	18	12	15	16	105	880
200 (8")	194	262	22	205	14	25	22	15	16	105	880
250 (10")	245	323	24	240	14	25	22	15	16	105	880
300 (12")	295	372	26	260	16	25	22	15	16	105	880
350 (14")	320	409	26	265	16	25	22	15	10	105	880
400 (16")	365	471	28	265	16	25	22	15	7	105	880
450 (18")	420	520	30	265	16	25	22	15	7	105	880
500 (20")	480	572	30	265	16	25	22	15	7	105	880
600 (24")	585	690	30	265	16	25	22	15	7	105	880
700 (28")	686	776	35	265	16	25	22	15	7	105	880 *
800 (32")	786	878	35	265	16	25	22	15	7	105	880
900 (36")	886	978	35	265	16	25	22	15	7	105	880
1000 (40")	986	1078	38	300	16	25	22	15	7	105	880
1100 (44")	1086	1180	38	300	16	25	22	15	7	105	880
1200 (48")	1180	1285	38	300	16	25	22	15	7	105	880
1400 (50")	1380	1500	38	300	16	25	22	15	7	105	880

GASKETS

TECHNICAL TEXTILES

EXPANSION JOINTS

INSULATION

NEW MATERIALS

Frenzelit GmbH  
P.O. Box 11 40  
95456 Bad Berneck  
Germany  
Phone +49 9273 72-0  
Fax +49 9273 72-102  
info@frenzelit.com  
www.frenzelit.com

 **Frenzelit**  
creating hightech solutions